

Addison Instrumentation

Tube Fittings

Male Connectors

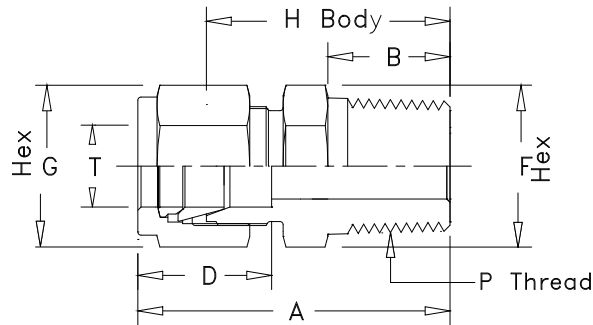

Available with NPT or BSPT threads

METRIC TUBE			Dimensions in mm					
Part No	T o/d	P	A Length	B	D	F	G Nut	H Body
6mMC2	6	1/8"	33.30	9.53	15.88	14	14	25.40
6mMC4	6	1/4"	37.9	14.20	15.88	14	14	30.16
6mMC6	6	3/8"	38.80	14.20	15.88	19	14	30.96
6mMC8	6	1/2"	44.45	19.00	15.88	22	14	36.51
8mMC2	8	1/8"	34.53	9.53	16.67	14	16	26.59
8mMC4	8	1/4"	39.20	14.20	16.67	14	16	31.35
10mMC2	10	1/8"	36.00	9.53	17.46	18	19	27.78
10mMC4	10	1/4"	40.48	14.20	17.46	18	19	32.54
10mMC6	10	3/8"	40.48	14.20	17.46	19	19	32.54
10mMC8	10	1/2"	46.50	19.00	17.46	22	19	38.10
10mMC12	10	3/4"	48.00	19.05	17.46	27	19	38.89
12mMC4	12	1/4"	43.66	14.20	23.02	22	22	33.34
12mMC6	12	3/8"	43.66	14.20	23.02	22	22	33.34
12mMC8	12	1/2"	49.00	19.00	23.02	22	22	38.10
12mMC12	12	3/4"	50.50	19.00	23.02	27	22	38.89
16mMC6	16	3/8"	44.45	14.20	24.61	24	27	34.13
16mMC8	16	1/2"	49.00	19.00	24.61	24	27	38.89
16mMC12	16	3/4"	49.00	19.00	24.61	27	27	38.89
18mMC8	18	1/2"	50.80	19.00	24.61	27	30	40.48
18mMC12	18	3/4"	50.80	19.00	24.61	27	30	40.48
18mMC16	18	1"	56.36	23.81	24.61	36	30	46.04
20mMC8	20	1/2"	52.30	19.00	24.61	30	32	42.20
20mMC12	20	3/4"	52.30	19.00	24.61	30	32	42.20
20mMC16	20	1"	56.36	23.80	24.61	36	32	46.04
25mMC12	25	3/4"	57.15	19.00	30.96	36	38	45.20
25mMC16	25	1"	62.50	3.90	30.96	36	38	50.00

INCH TUBE			Dimensions in inches					
Part No	T o/d	P	A Length	B	D	F	G Nut	H Body
2MC2	1/8	1/8	1.19	0.38	0.53	7/16	7/16	0.94
2MC4	1/8	1/4	1.41	0.56	0.53	9/16	7/16	1.13
3MC2	3/16	1/8	1.21	0.38	0.54	7/16	1/2	0.95
3MC4	3/16	1/4	1.42	0.56	0.54	9/16	1/2	1.16
4MC1	1/4	1/16	1.29	0.38	0.60	1/2	9/16	1.00
4MC2	1/4	1/8	1.29	0.38	0.60	1/2	9/16	1.00
4MC4	1/4	1/4	1.00	0.56	0.63	9/16	9/16	1.20
4MC6	1/4	3/8	1.48	0.56	0.60	11/16	9/16	1.22
4MC8	1/4	1/2	1.48	0.75	0.60	7/8	9/16	1.47
5MC2	5/16	1/8	1.50	0.38	0.64	9/16	5/8	1.05
5MC4	5/16	1/4	1.00	0.56	0.64	9/16	5/8	1.23
6MC2	3/8	1/8	1.66	0.38	0.66	5/8	11/16	1.10
6MC4	3/8	1/4	1.66	0.56	0.66	5/8	11/16	1.28
6MC6	3/8	3/8	1.00	0.56	0.66	11/16	11/16	1.28
6MC8	3/8	1/2	1.50	0.75	0.66	7/8	11/16	1.50
6MC12	3/8	3/4	1.88	0.75	0.66	1-1/16	11/16	1.59
8MC4	1/2	1/4	1.00	0.56	0.90	13/16	7/8	1.31
8MC6	1/2	3/8	1.00	0.56	0.90	13/16	7/8	1.31
8MC8	1/2	1/2	1.80	0.75	0.90	7/8	7/8	1.50
8MC12	1/2	3/4	1.80	0.75	0.90	1-1/16	7/8	1.53
10MC6	5/8	3/8	1.36	0.56	0.96	15/16	1	1.34
10MC8	5/8	1/2	1.93	0.75	0.96	15/16	1	1.53
10MC12	5/8	3/4	1.99	0.75	0.96	1-1/16	1	1.59
12MC8	3/4	1/2	1.99	0.75	0.96	1-1/16	1-1/8	1.59
12MC12	3/4	3/4	1.99	0.75	0.96	1-1/16	1-1/8	1.59
12MC16	3/4	1	2.25	0.94	0.96	1-3/8	1-1/8	1.85
16MC12	1	3/4	2.26	0.75	1.23	1-3/8	1-1/2	1.78
16MC16	1	1	2.45	0.94	1.23	1-3/8	1-1/2	1.97

Dimension are for reference only, and subject to change.