

Addison Instrumentation

Tube Fittings

Plugs

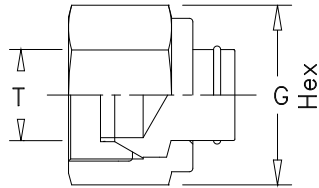

METRIC TUBE		Dimensions in mm	
Part No	T o/d	G Nut	
4mF PLUG	4	12	
6mF PLUG	6	14	
8mF PLUG	8	16	
10mF PLUG	10	19	
12mF PLUG	12	22	
16mF PLUG	16	27	
18mF PLUG	18	30	
20mF PLUG	20	32	
25mF PLUG	25	38	

INCH TUBE		Dimensions in inches	
Part No	T o/d	G Nut	
1F PLUG	1/16	5/16	
2F PLUG	1/8	7/16	
3F PLUG	3/16	1/2	
4F PLUG	1/4	9/16	
5F PLUG	5/16	5/8	
6F PLUG	3/8	11/16	
8F PLUG	1/2	7/8	
10F PLUG	5/8	1	
12F PLUG	3/4	1-1/8	
16F PLUG	1	1-1/2	

Union Elbows

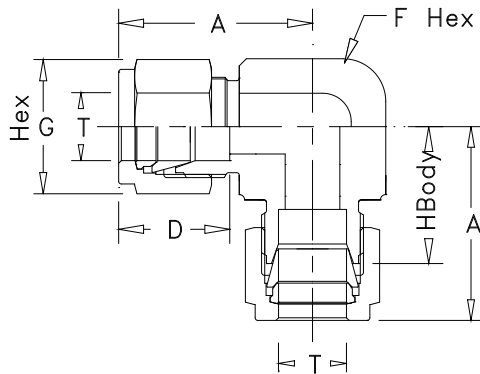

METRIC TUBE		Dimensions in mm				
Part No.	T o/d	A	D	F	G Nut	H Body
6mELU	6	27.00	15.30	12	14	19.81
8mELU	8	28.80	16.20	16	16	22.20
10mELU	10	31.50	17.20	17	19	23.90
12mELU	12	36.00	22.80	22	22	25.90
16mELU	16	38.00	24.40	24	27	27.90
18mELU	18	39.80	24.40	27	30	29.17
20mELU	20	44.60	26.00	32	32	34.50
25mELU	25	49.10	31.30	35	38	36.80

INCH TUBE		Dimensions in inches				
Part No.	T o/d	A Length	D	F	G Nut	H Body
2ELU	1/8	0.94	0.53	3/8	7/16	0.72
3ELU	3/16	1.01	0.54	1/2	1/2	0.75
4ELU	1/4	1.07	0.60	1/2	9/16	0.78
5ELU	5/16	1.17	0.64	9/16	5/8	0.88
6ELU	3/8	1.20	0.66	5/8	11/16	0.91
8ELU	1/2	1.42	0.90	13/16	7/8	0.98
10ELU	5/8	1.50	0.96	15/16	1	1.06
12ELU	3/4	1.57	0.96	1-1/16	1-1/8	1.17
16ELU	1	1.93	1.23	1-3/8	1-1/2	1.45

Dimension are for reference only, and subject to change.